

12. Rear End Panel

The rear end panel is supplied as a complete assembly. The tail lamp pockets are attached to the quarter panels (figure 12-1).

Remove or Disconnect

1. Remove all related panels and components.
2. Visually inspect and restore as much of the damage as possible to factory specifications.
3. Locate, mark, and drill out all the factory welds.
4. Remove the damaged section of the rear end panel.

Install or Connect

1. Position the service panel, check the fit, and plug weld accordingly (figure 12-1).
2. Clean and prepare welded surfaces. Apply sealers and anti-corrosion materials as necessary.
3. Prime with two-part catalyzed primer. Do not combine paint systems. Refer to paint manufacturer's recommendations.
4. Install all related panels and components.

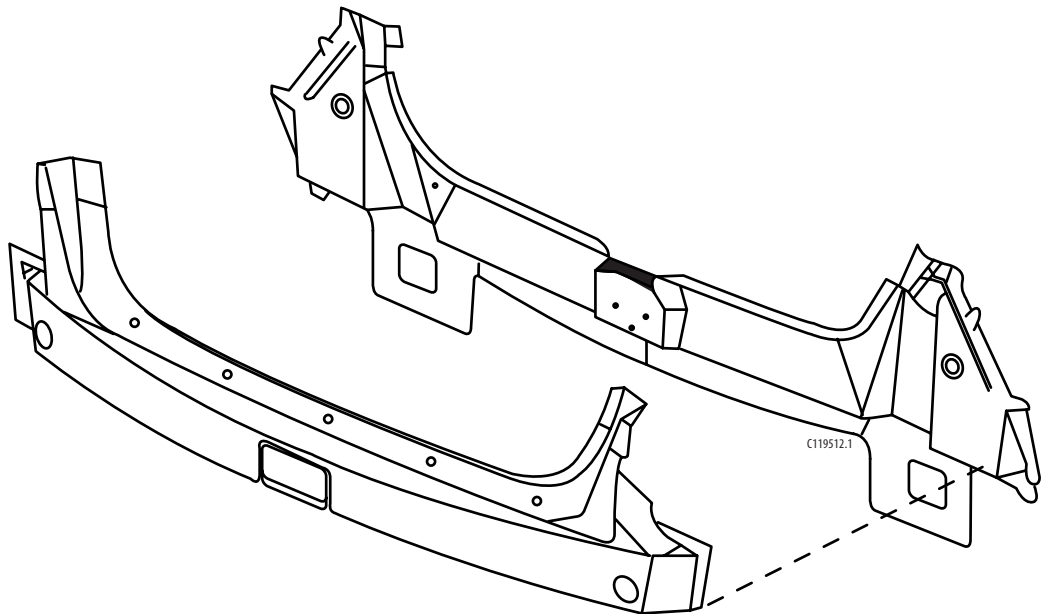

Figure 12-1:
Rear End Panel Assembly