

14. BODY DIMENSIONS

UNDERBODY

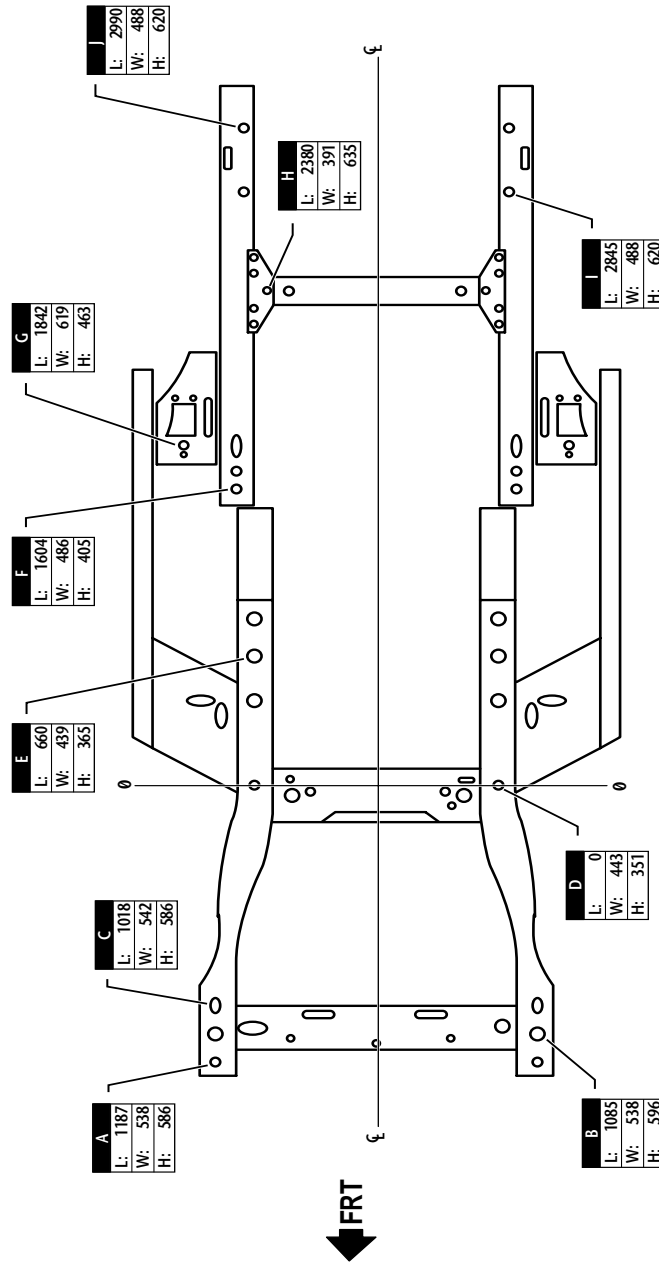

ALL DIMENSIONS ARE MEASURED FROM A ZERO LINE, CENTER LINE, AND A COMMON DATUM. ALL DIMENSIONS ARE SYMMETRICAL UNLESS OTHERWISE SPECIFIED. SEE PAGE 42 FOR HOLE IDENTIFICATION.

BODY DIMENSIONS

FRONT

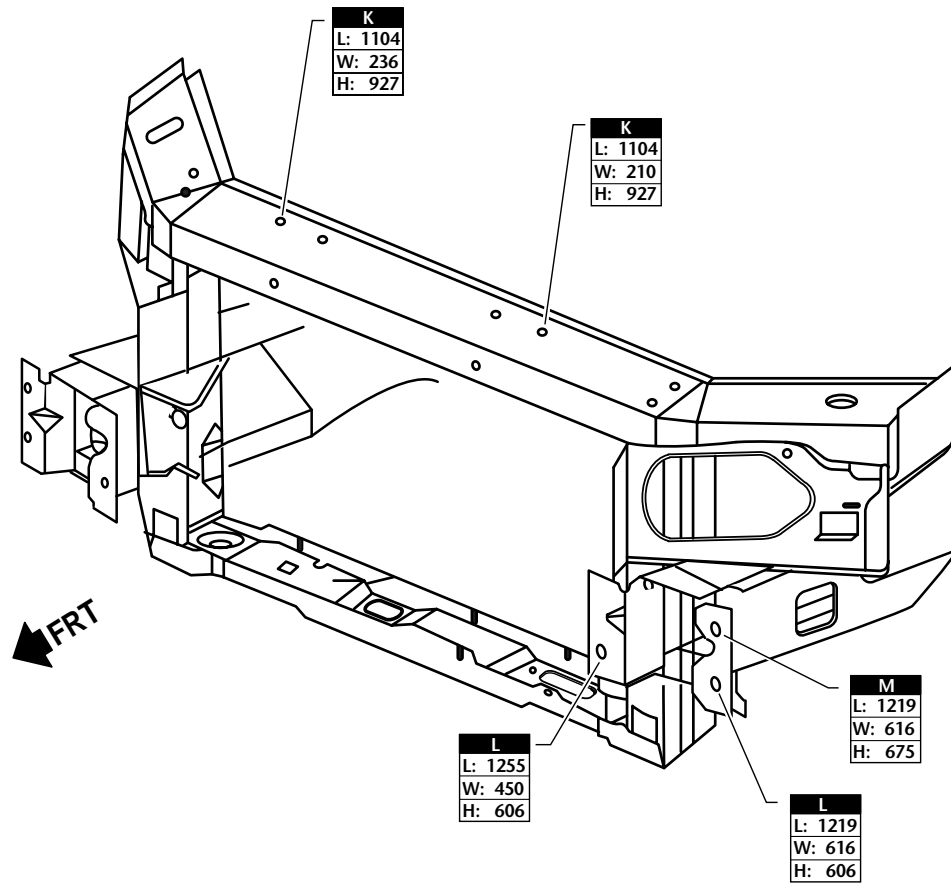

ALL DIMENSIONS ARE MEASURED FROM A ZERO LINE,
CENTER LINE, AND A COMMON DATUM.
ALL DIMENSIONS ARE SYMMETRICAL UNLESS OTHERWISE SPECIFIED.
SEE PAGE 42 FOR HOLE IDENTIFICATION.

ENGINE COMPARTMENT

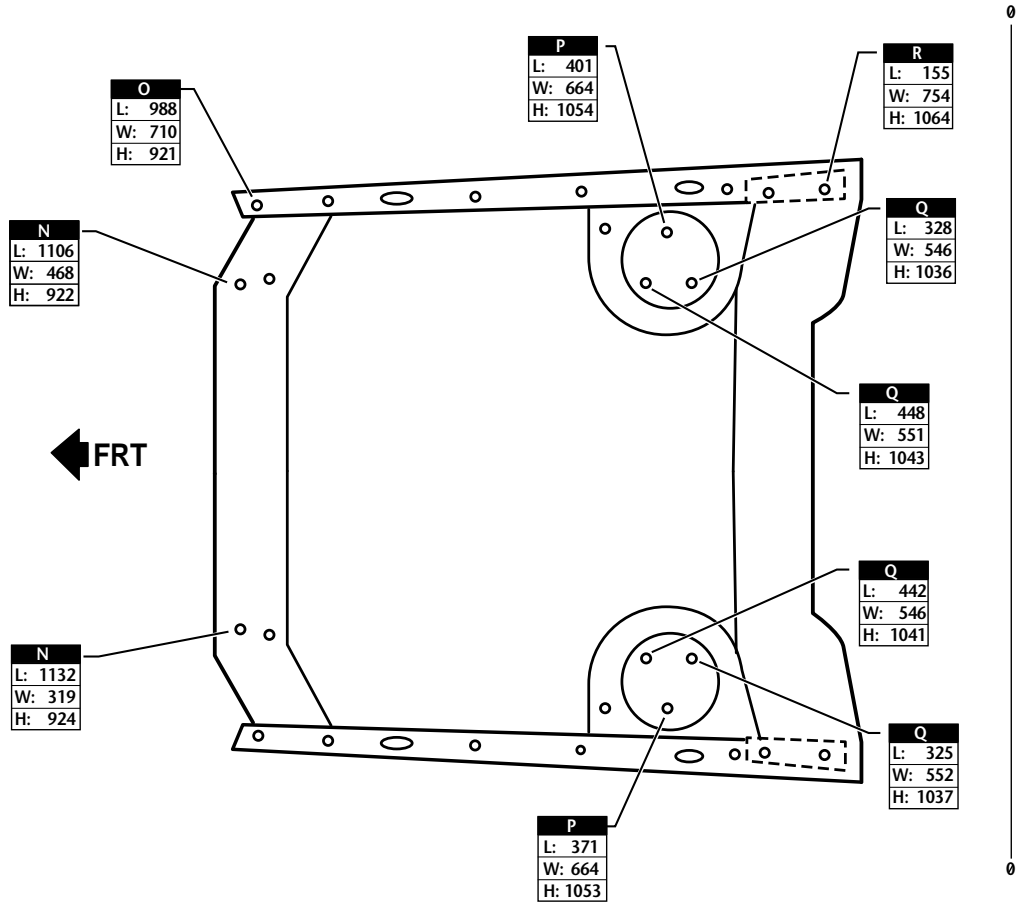

ALL DIMENSIONS ARE MEASURED FROM A ZERO LINE, CENTER LINE, AND A COMMON DATUM. ALL DIMENSIONS ARE SYMMETRICAL UNLESS OTHERWISE SPECIFIED. SEE PAGE 42 FOR HOLE IDENTIFICATION.

BODY DIMENSIONS

BUICK CENTURY DOOR FRAME OPENING

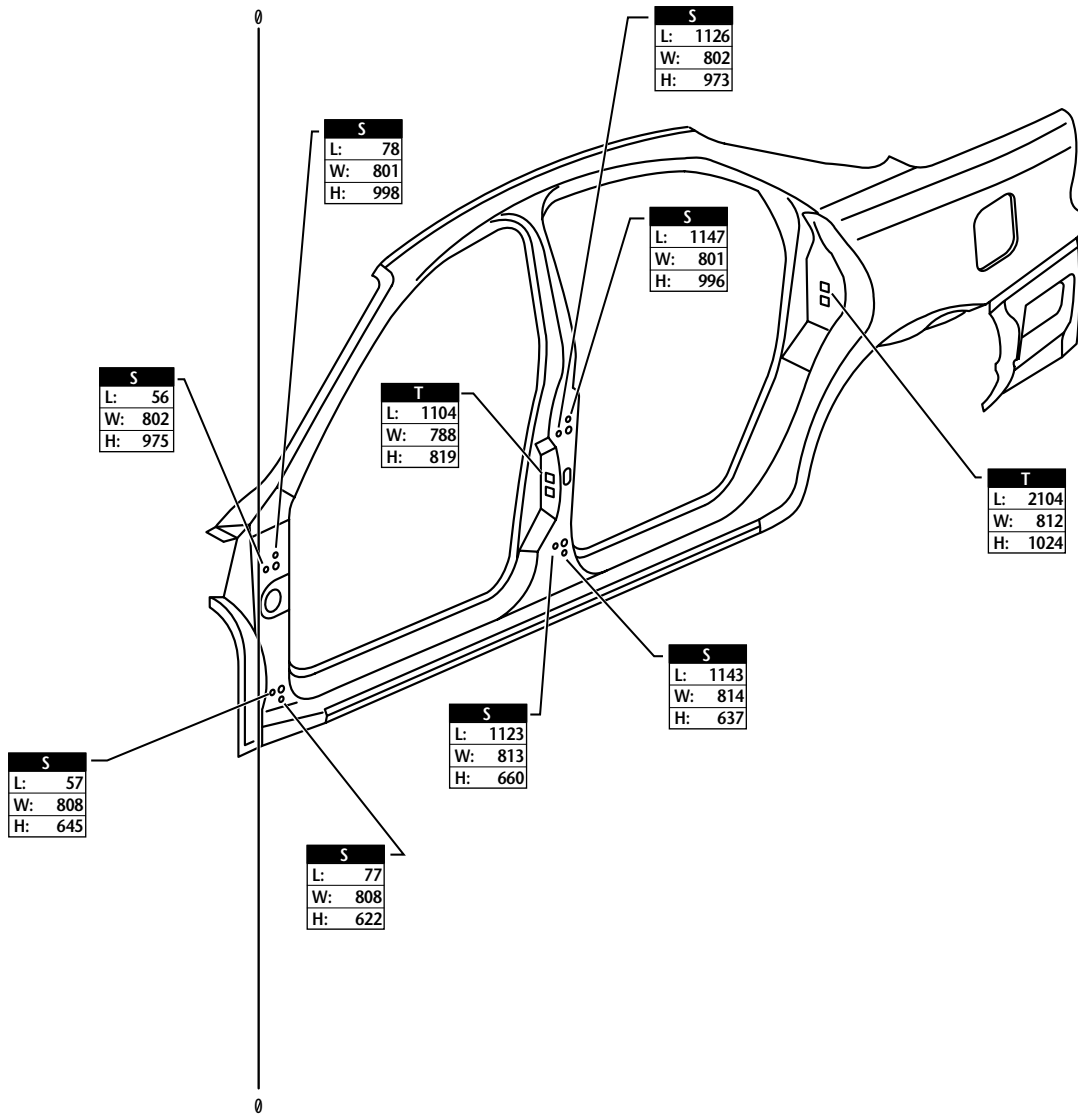

ALL DIMENSIONS ARE MEASURED FROM A ZERO LINE, CENTER LINE, AND A COMMON DATUM. ALL DIMENSIONS ARE SYMMETRICAL UNLESS OTHERWISE SPECIFIED. SEE PAGE 42 FOR HOLE IDENTIFICATION.

OLDSMOBILE INTRIGUE DOOR FRAME OPENING

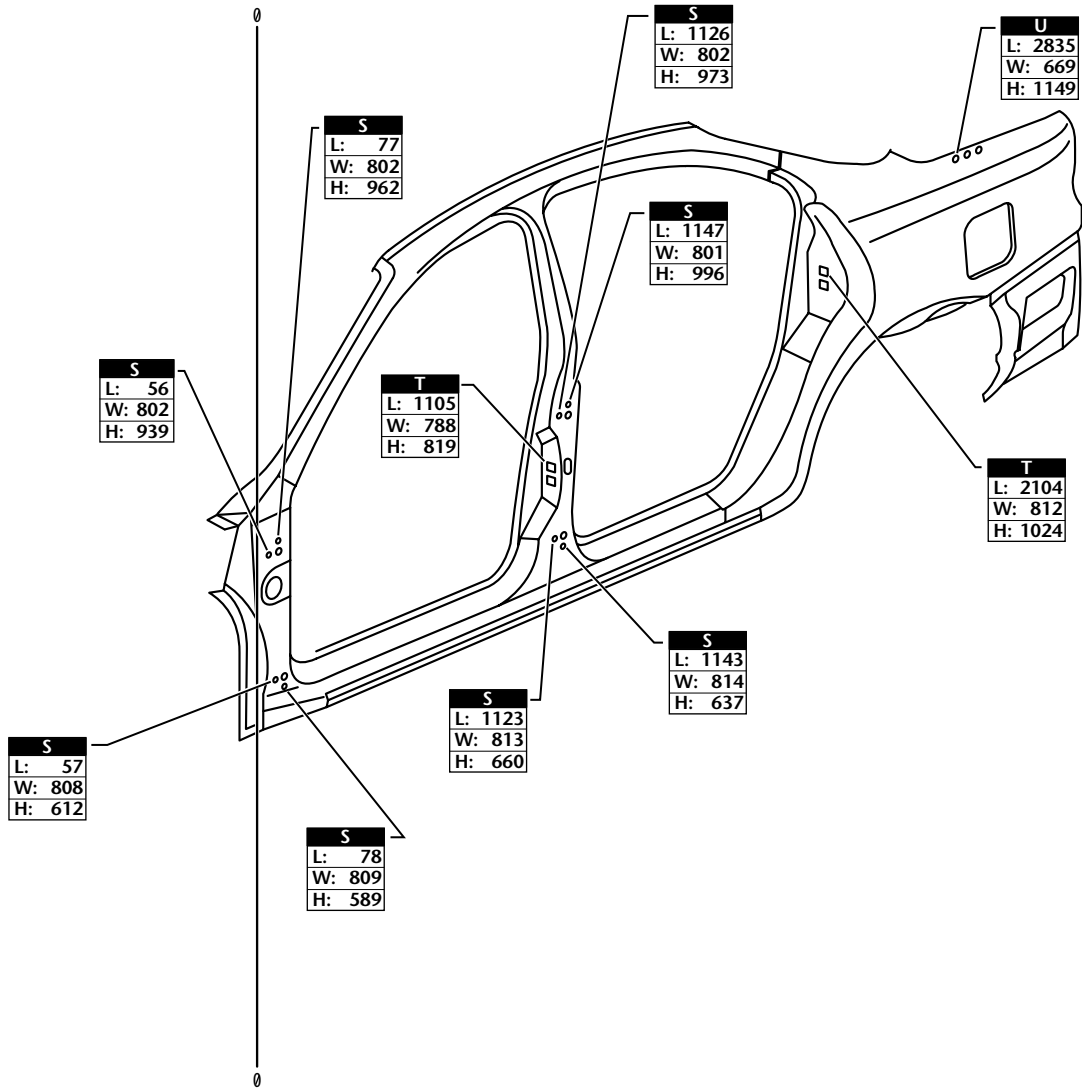

ALL DIMENSIONS ARE MEASURED FROM A ZERO LINE, CENTER LINE, AND A COMMON DATUM. ALL DIMENSIONS ARE SYMMETRICAL UNLESS OTHERWISE SPECIFIED. SEE PAGE 42 FOR HOLE IDENTIFICATION.

BODY DIMENSIONS

REAR

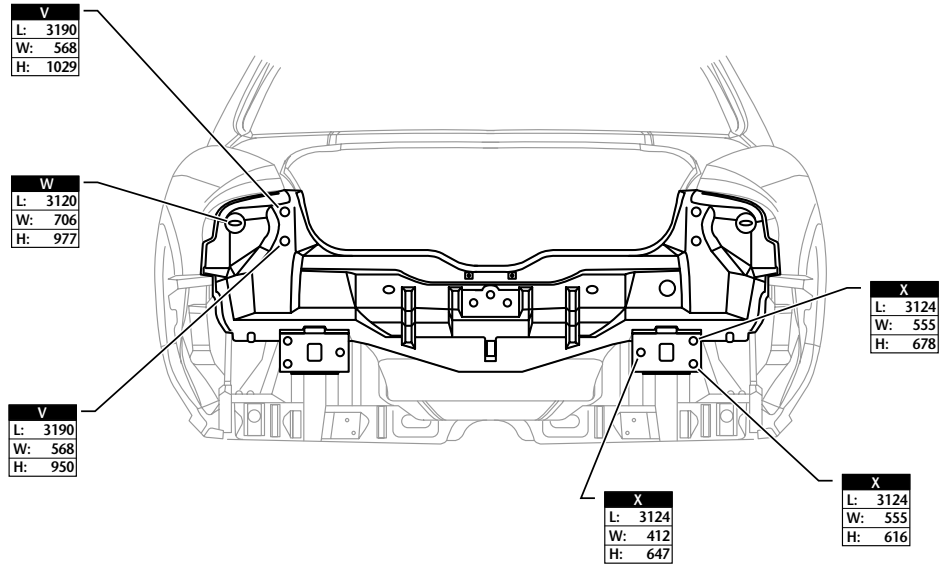

BUICK CENTURY

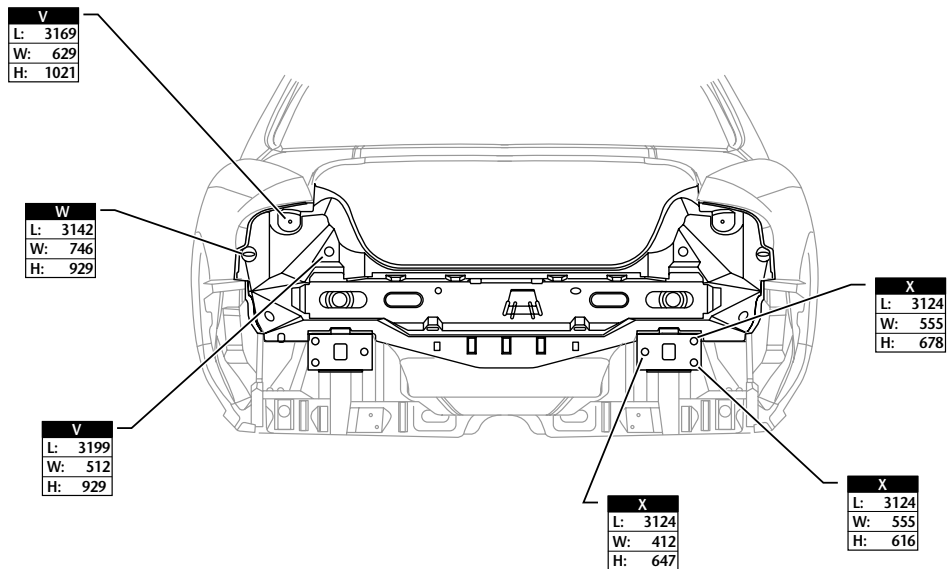

OLDSMOBILE INTRIGUE

ALL DIMENSIONS ARE MEASURED FROM A ZERO LINE, CENTER LINE, AND A COMMON DATUM. ALL DIMENSIONS ARE SYMMETRICAL UNLESS OTHERWISE SPECIFIED. SEE PAGE 42 FOR HOLE IDENTIFICATION.

FORM AND PIERCE

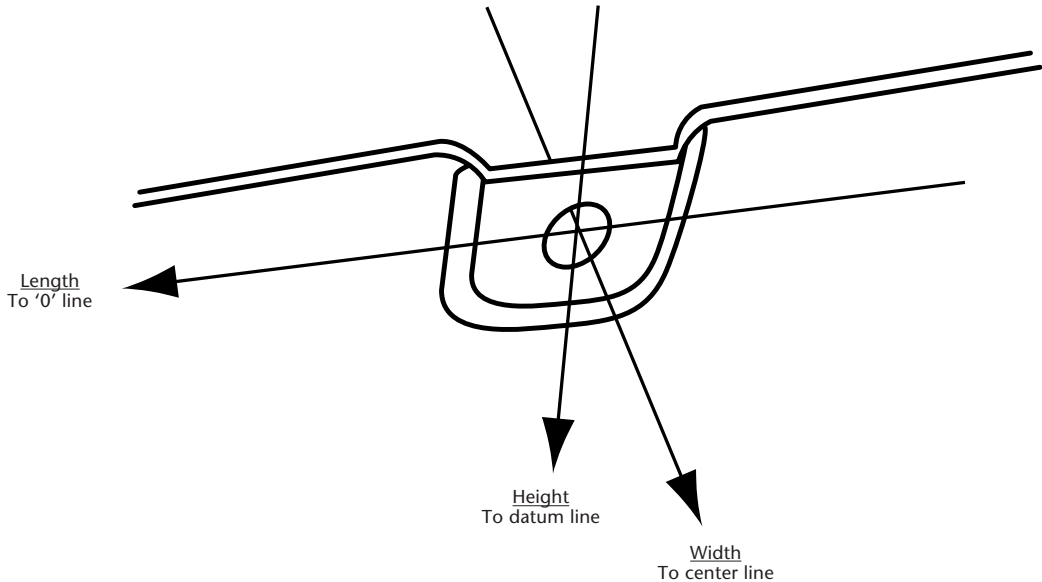

ALL MEASUREMENTS ARE READ FROM FORMED SURFACE AND CENTER OF HOLE

DIE MARKS TO INDICATE SECTIONING

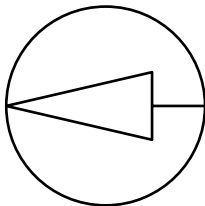

FRONT RAIL DIE MARK

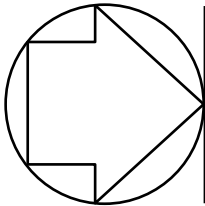

REAR RAIL DIE MARK

ALL DIMENSIONS ARE MEASURED FROM A ZERO LINE, CENTER LINE, AND A COMMON DATUM. ALL DIMENSIONS ARE SYMMETRICAL UNLESS OTHERWISE SPECIFIED. SEE PAGE 42 FOR HOLE IDENTIFICATION.

Buick Century/Oldsmobile Intrigue Hole Identification Chart

Letter	Quantity	Feature Size	Usage
A	1 per side	38mm	Gage hole
B	1 per side	22mm	Cradle attach
C	1 per side	12mm x 18mm slot	Gage slot
D	1 per side	12mm	Gage hole
E	3 per side	16mm	Gage hole
F	2 per side	19mm	Gage hole
G	1 per side	12mm	Gage hole
H	1 per side	30mm	Gage hole
I	1 per side	18mm x 21mm slot	Gage slot
J	1 per side	19mm x 23mm slot	Gage slot
K	3 per side	7mm (punched hole)	Upper engine mounting attach
L	2 per side	16mm	Bumper bar attach
M	1 per side	9mm x 18 mm	Bumper bar attach
N	2 per side	Weld nuts	Support brace
O	6 per side	5mm (punched hole)	Fender attach
P	1 per side	12mm	Front suspension attach
Q	2 per side	12mm x 15mm slot	Front suspension attach
R	2 per side	Weld nuts	Hood hinge attach
S	8 per side	Hinge mount	Door attach
T	4 per side	Clinch nut	Lock striker attach
U	3 per side	Weld nuts	Deck lid hinge attach (Intrigue)
V	2 per side	11mm pierced hole 5mm pierced hole	Tail light attach
W	1 per side	5mm x 11mm slot	Tail light attach
X	3 per side	16mm	Rear bumper attach