

SIR Disabling and Enabling Zone 8

Disabling Procedure

1. Turn the steering wheel so that the vehicles wheels are pointing straight ahead.
2. Turn the ignition switch to the OFF position.
3. Remove the key from the ignition switch.
4. Locate the body control module (BCM) fuse center then remove fuse center cover.

Important: This inflatable restraint sensing and diagnostic module (SDM) has two fused power inputs. To ensure there is no unwanted SIR deployment, personal injury, or unnecessary SIR system repairs, remove both AIR BAG (IGN) and AIR BAG (BATT) fuses from the BCM fuse center. With the AIR BAG fuses removed and the ignition switch in the ON position, the AIR BAG warning indicator illuminates. This is normal operation, and does not indicate an SIR system malfunction.

5. Locate and remove the AIR BAG (IGN) and AIR BAG (BATT) fuses from the BCM fuse center.
6. Remove the garnish molding from the right upper lock pillar. Refer to *Garnish Molding Replacement - Rear Corner Upper*.
7. Remove the connector position assurance (CPA) from the roof rail module-right connector.
8. Disconnect the roof rail module-right connector from the vehicle harness connector.

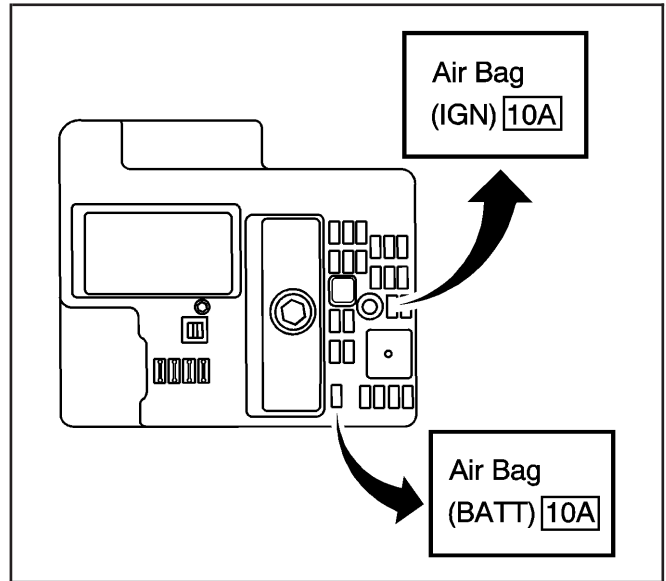

1316302

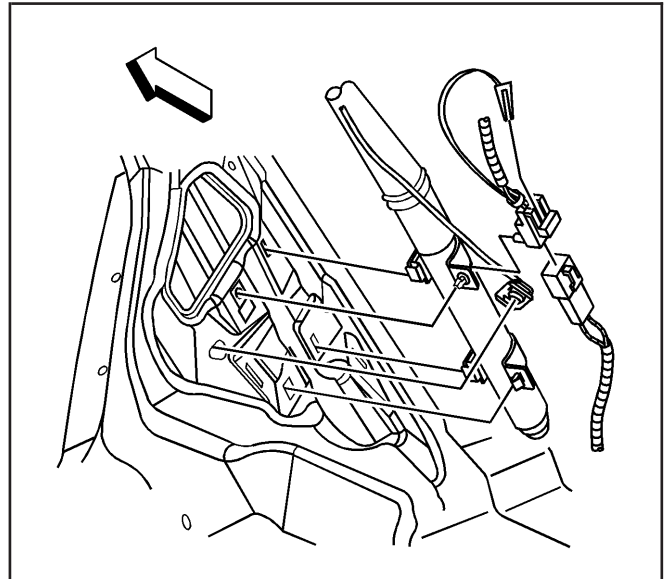

899820

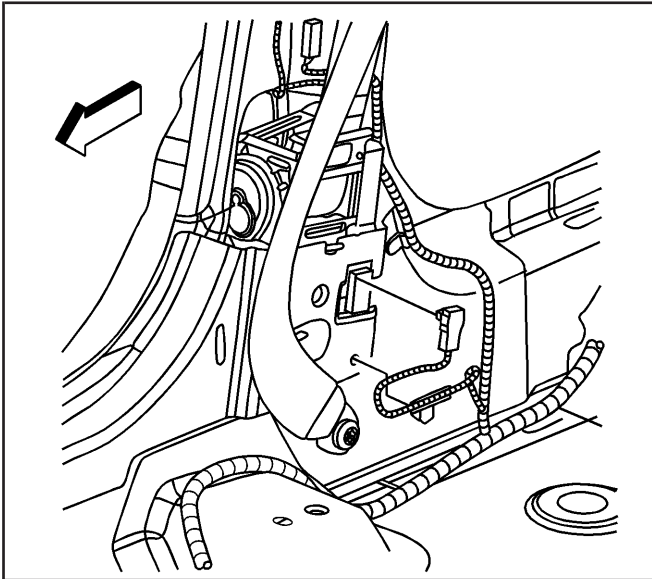

899818

9. Remove the lower right center pillar trim. Refer to *Garnish Molding Replacement - Center Pillar Lower*.
10. Remove the CPA from seat belt pretensioner-RF connector.
11. Disconnect the seat belt pretensioner-RF connector from the vehicle harness connector.

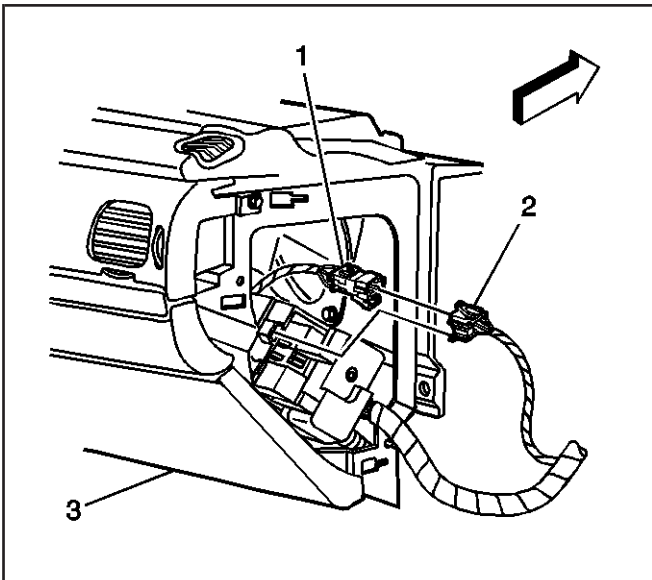

816857

12. Remove the passenger/right outer trim cover from the instrument panel (I/P) (3). Refer to *Instrument Panel (I/P) Outer Trim Cover Replacement*.
13. Remove the CPA from the I/P module connector (1).
14. Disconnect the I/P module connector (1) from the vehicle harness connector (2).

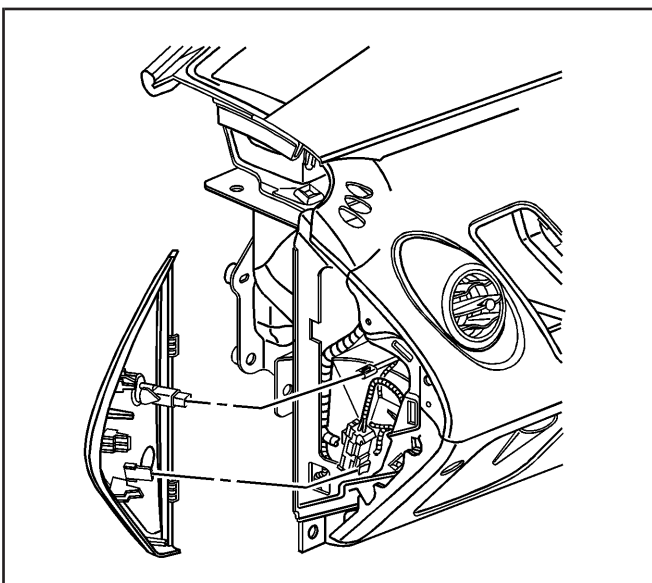

877766

15. Remove the driver/left outer trim cover from the I/P. Refer to *Instrument Panel (I/P) Outer Trim Cover Replacement*.
16. Remove the CPA from the steering wheel module coil connector.
17. Disconnect the steering wheel module coil connector from the vehicle harness connector.

18. Remove the lower left center pillar trim. Refer to *Garnish Molding Replacement - Center Pillar Lower*.
19. Remove the CPA from seat belt pretensioner-LF connector.
20. Disconnect the seat belt pretensioner-LF connector from the vehicle harness connector.

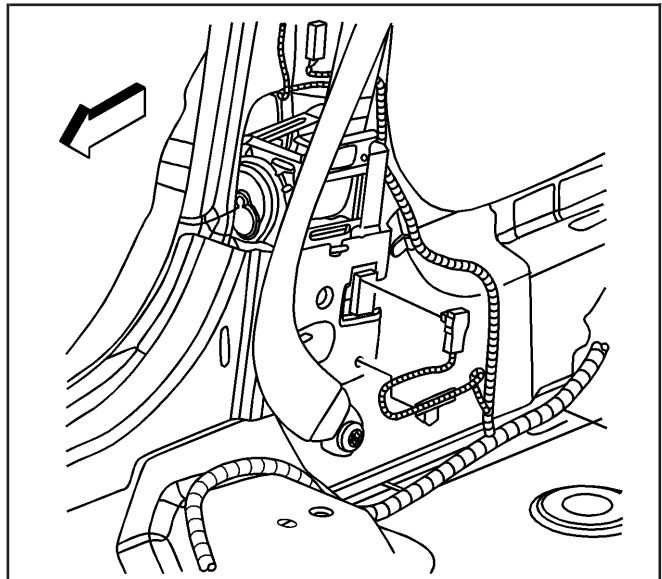

899818

21. Remove the garnish molding from the left upper lock pillar. Refer to *Garnish Molding Replacement - Rear Corner Upper*.
22. Remove the CPA from the roof rail module-left connector.
23. Disconnect the roof rail module-left connector from the vehicle harness connector.

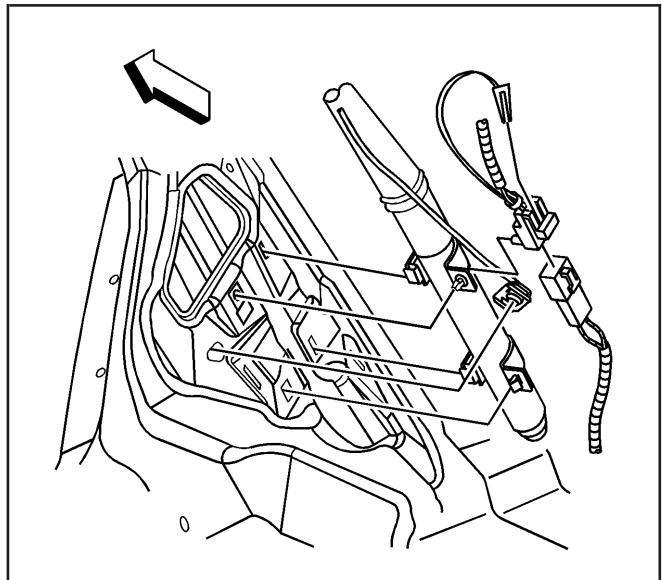

899820

Enabling Procedure

1. Remove the key from the ignition switch.
2. Connect the roof rail module-left connector to the vehicle harness connector.
3. Install the CPA to the roof rail module-left connector.
4. Install the garnish molding to the left upper lock pillar. Refer to *Garnish Molding Replacement - Rear Corner Upper*.

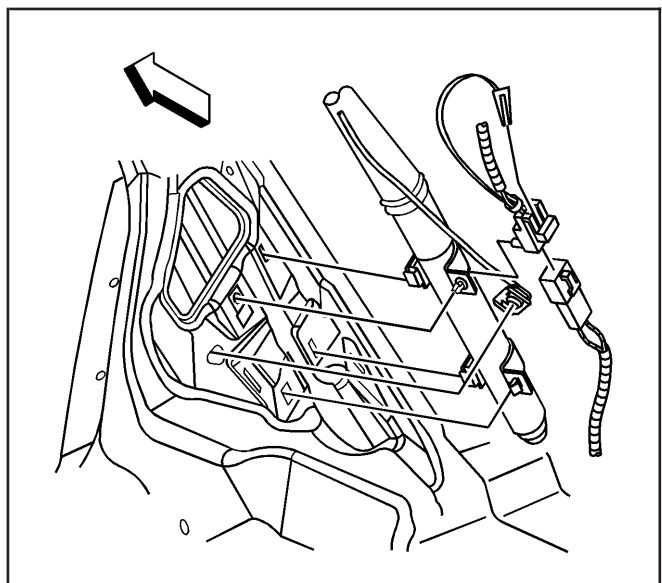

899820

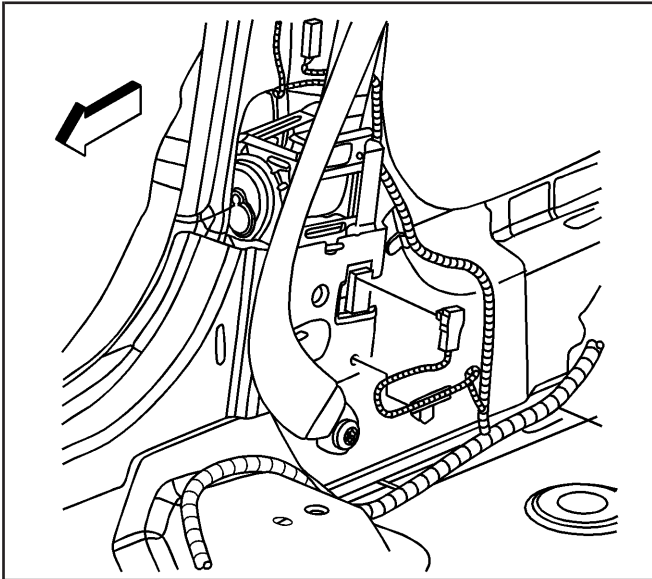

899818

5. Connect the seat belt pretensioner-LF connector.
6. Install the CPA to the seat belt pretensioner-LF connector.
7. Install the left/driver lower center pillar trim. Refer to *Garnish Molding Replacement - Center Pillar Lower*.

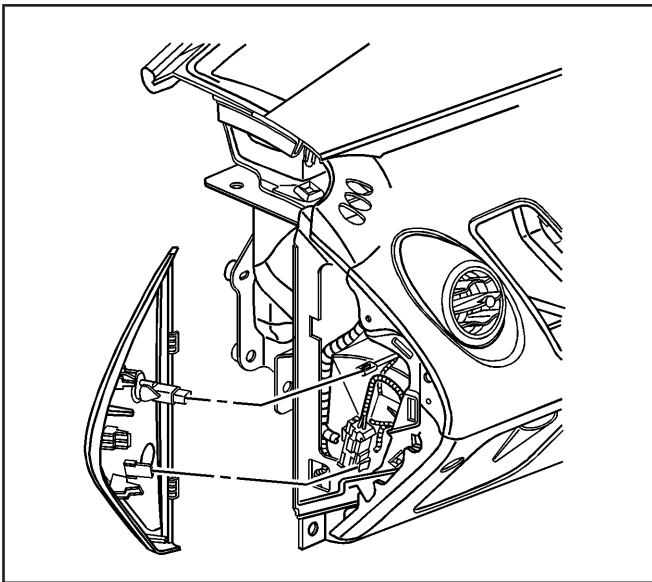

877766

8. Connect the steering wheel module coil connector to the vehicle harness connector.
9. Install the CPA to the steering wheel module coil connector.
10. Install the driver/left outer trim cover to the I/P. Refer to *Instrument Panel (I/P) Outer Trim Cover Replacement*.

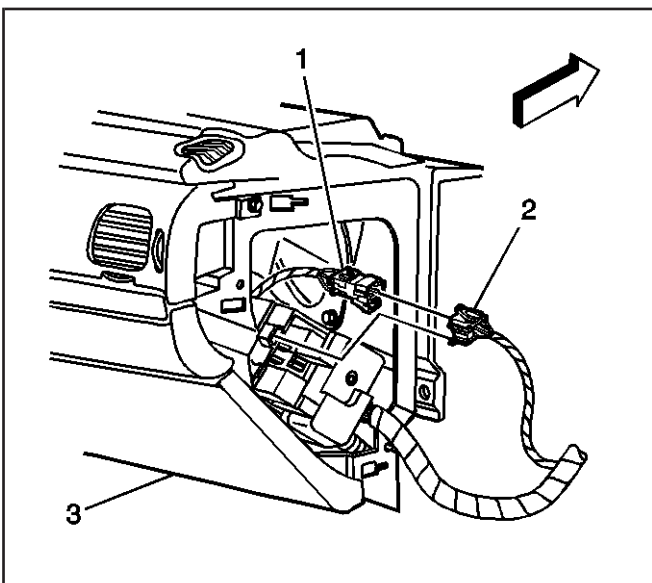

816857

11. Connect the I/P module connector (1) to the vehicle harness connector (2).
12. Install the CPA to the I/P module connector (1).
13. Install the passenger/right outer trim cover to the I/P (3). Refer to *Instrument Panel (I/P) Outer Trim Cover Replacement*.

14. Connect the seat belt pretensioner-RF connector.
15. Install the CPA to the seat belt pretensioner-RF connector.
16. Install the right lower center pillar trim. Refer to *Garnish Molding Replacement - Center Pillar Lower*.

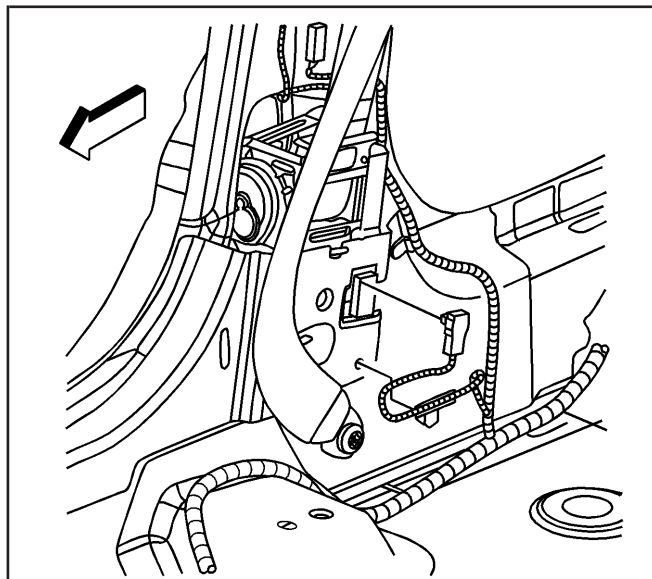

899818

17. Connect the roof rail module-right connector to the vehicle harness connector.
18. Install the CPA to the roof rail module-right connector.
19. Install the garnish molding to the right upper lock pillar. Refer to *Garnish Molding Replacement - Rear Corner Upper*.

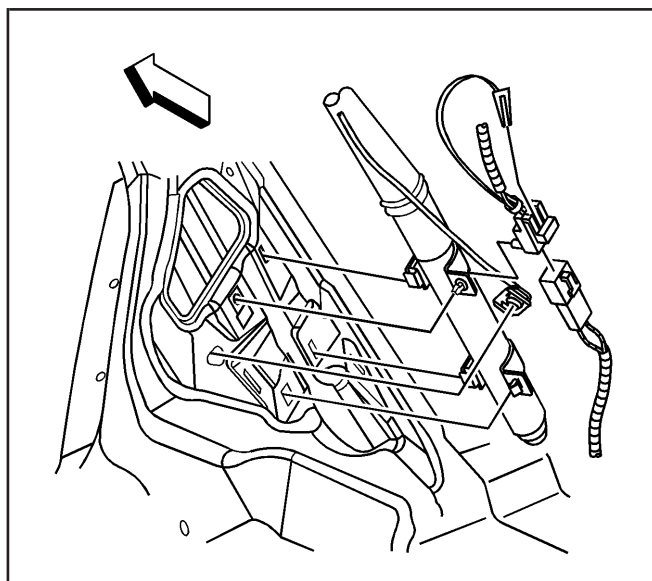

899820

20. Install the AIR BAG (IGN) and AIR BAG (BATT) fuses into the BCM fuse center.
21. Install the BCM fuse center cover.
22. Use caution while reaching in and turn the ignition switch to the ON position.
The AIR BAG indicator will flash then turn OFF.
23. Perform the Diagnostic System Check – Vehicle if the AIR BAG warning indicator does not operate as described. Refer to *Diagnostic System Check - Vehicle*.

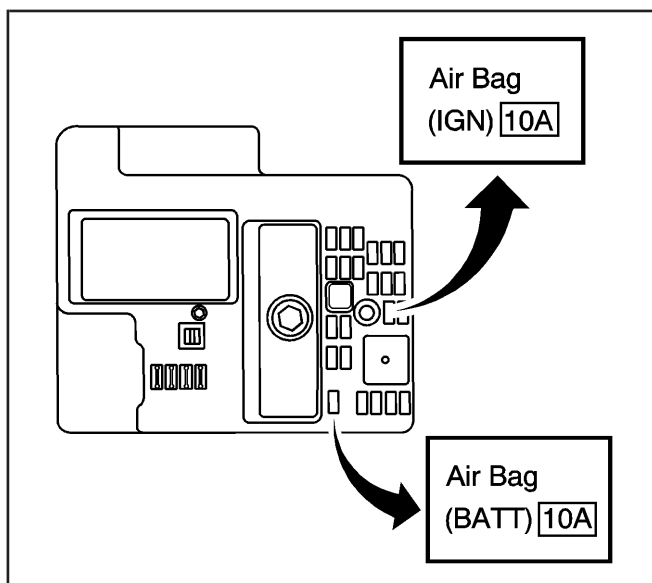

1316302